

EN

SCHNEESTERN

action sports engineered



S SKATE





Most of the population likes to communicate and move. So, it is hardly surprising that we are increasingly looking for sporting activities not only in clubs but also in everyday life. Modern sporting facilities are both social meeting-points and open spaces for movement. Our skateparks take up this philosophy.

Today, when we speak of skateboard facilities, we refer to a broad social acceptance, as well as a huge following of young activists. The number of new riders in the field of roller sports has been constantly growing for years. A development that is due to the recognition of "Skateboarding" as an Olympic discipline, but also due to the provision of appropriate sporting facilities.

It is an indisputable fact that an offer of freely accessible sporting facilities provides great benefits for both human health and society. At this point, together with you, we would like to think in a new and most of all contemporary way. What priorities have you set for your city, municipality or tourist region in terms of promoting physical activity and the attractiveness of your location? Do these priorities allow you to address children, young people and adults? When it comes to your offer for a modern society, what steps need to be taken to create an appealing sporting facility?

How are you already perceiving this change in the open space and what does the future of individual sports look like for you?

Immerse yourself into the world of skate parks and let yourself be inspired by our solutions.

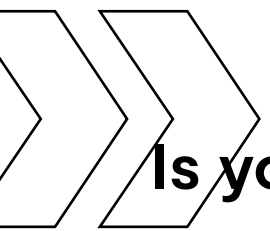

Is your offer for a sports facility attractive, contemporary and target-oriented?

In-order for the **health** and **social added value** of sports facilities to take effect, an important **basic prerequisite** must be met: The facilities must be tailored to the **current sports behavior** of the **population**.



Are you currently able to meet the demand for the promotion of physical activity?



In Germany, every **fifth child** and every **second adult** are **overweight**, a development that symbolizes Western society. What **programs** or **measures** can a municipality offer to **counter this development**?



Free space is valuable. Do you utilize it?

Outdoor leisure activities are a **valuable asset**. Not only monetary, but also from a health point of view. Accordingly, **available areas** should be used as **effectively** and well-thought-out as possible.

Skateparks - Efficient use of free space

Skate shoes, which are now regarded as conventional fashion accessories, bankers who ride their skateboards through pedestrian zones on their way to the office. A skateboard professional invited to the White House by the US President to show his tricks in the corridors: no doubt skateboarding is widely accepted in today's society. Even small rural municipalities finance small skateparks and in large European cities, several of these facilities can be found throughout the entire urban area.

Skating is a sport, skating is fashion, skating is iconic and above all, it has become a worldwide youth culture. It is estimated that there are over 21 million active skateboarders. A huge movement that has developed rapidly in the last 25 years becoming one of the most stable and important global sporting cultures.

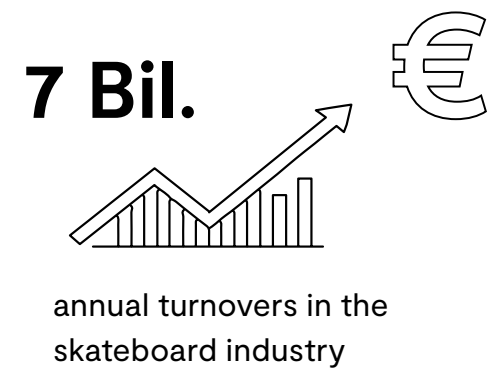

Skateboarding is physical exercise, which also has a great social and integrative added value. Borders, ethnic groups and social classes are overcome. However, skateboarding can also be considered of great economic importance.

Sales figures are growing almost everywhere, and the Financial Times estimates that the worldwide sales of skateboards, accessories and clothing totaled to

21 million

Skaters worldwide



>> BMX FREESTYLE, SKATEBOARD STREET & SKATEBOARD PARK WILL BE OLYMPIC DISCIPLINES FROM 2020 ONWARDS.



"The Tokyo program reform has three objectives: Increased youthfulness, more femininity and taking the urbanization of sport into account. We can no longer wait for young people to come to us. Therefore, we have to go where the young people are."

Thomas Bach, IOC President

around seven billion euros in 2010. The combination of these various points of view depicts this and illustrates why the sport "Skateboarding" and roller sports in general, gain more and more importance while reflecting the sports behavior of children and teenagers. A fact that is also reflected by skateboarding and BMX having been included in the program of the Olympic Games. A groundbreaking step for a young sport and a further development of the traditional definition of the sport.

Skateparks – Efficient use of free space

» Problem:

Little space – high demands!

During the last 60 years, the land used for housing and transport in Germany has more than doubled. The consequences of this "land loss" are diverse. Thus, due to its finiteness, available spaces become more and more important and valuable. Considering this development, urban open spaces have a special role to play – they are scarce resources. Public spaces in cities that can be used for playing, sports and free movement must be used efficiently. On the one hand, there is the problem that open spaces are being diminished or not even planned. On the other hand, there is a "revival" of the public space as a place for private leisure activities, which pays more attention to the changing needs of people for self-determined activities.

Considering that a municipality must cope with far greater problems – such as the increasing density of living space, the difficult financial situation, the development of the population and the city itself, what can be recommended in this interplay? Open spaces are becoming a scarce luxury when work, housing and prosperity come first.

Tennis court

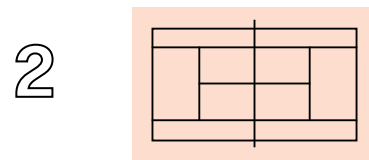

Active users: 2 - 4
 Area: approx. 700 m²
 Cost per m²: 94 €
 Tennis court made of brick sand flour featuring floodlights
 Operating life 20 years

Skate park

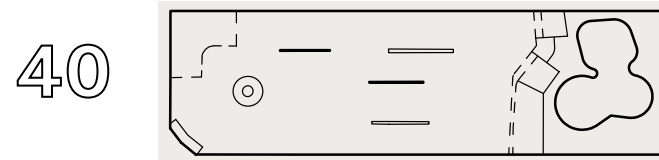

Active users: 40
 Area: approx. 1000 m²;
 Costs per m²: 416 € in-situ concrete
 Skate park featuring floodlights
 Operating life 25 years

Soccer field

22

Active users: 22
 Area: approx. 7100 m²
 Cost per m²: 77 €
 Artificial turf featuring floodlights
 Operating life 23 years

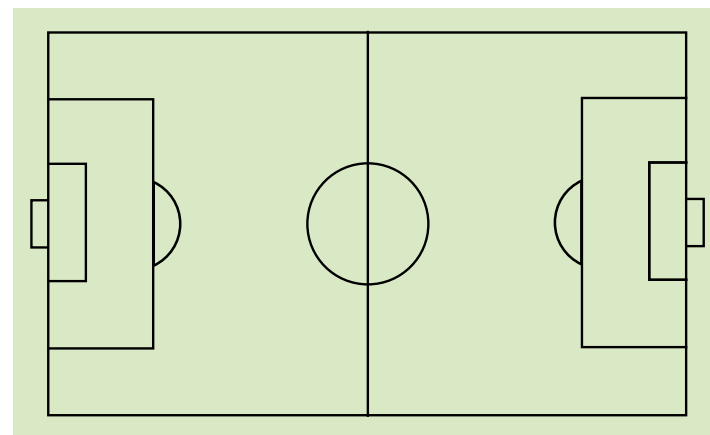

source: Sportsstättenrechner.com

Initial investment per user area (IPU)

The added value of a sports facility is also limited by the maximum number of users. For this reason, we believe it is sensible to compare this number with the initial costs and the area. This illustrates how low the "per capita costs" can work out to be for the athletic participants when building a new facility with a high number of users.

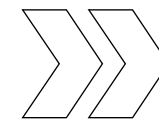

The smaller the IPU of a sporting facility, the more attractive the investment.

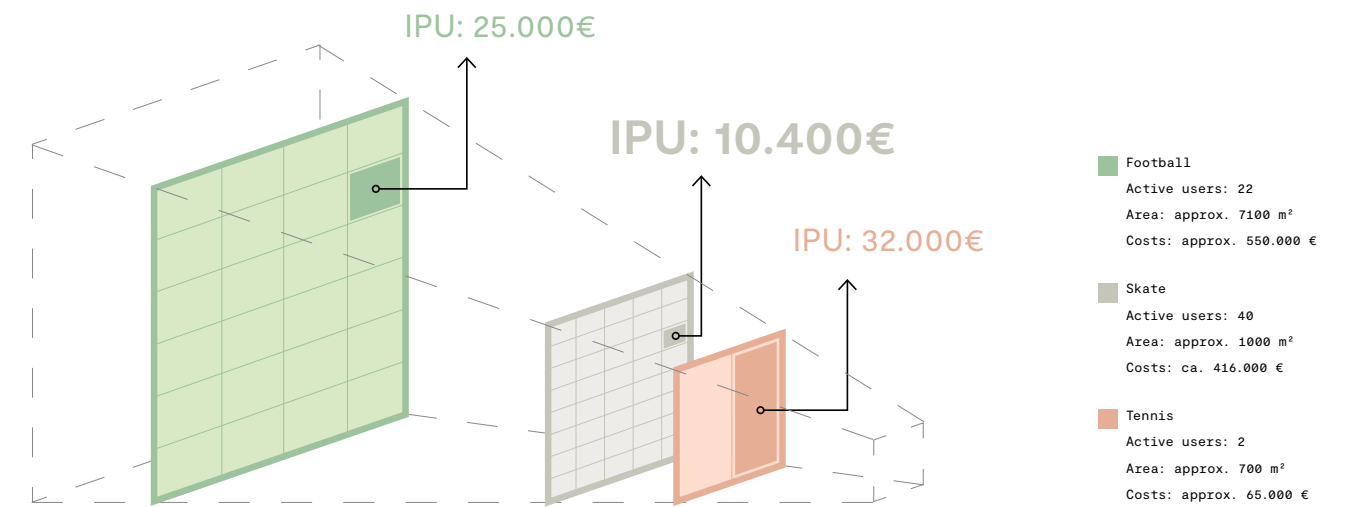

» Solution:

The skatepark as a contemporary sporting facility with efficient use of space!

We need sporting facilities which, in comparison to the requirements of other sports such as soccer, already achieve a great effect on a small area. Roller sports facilities do not only impress due to the broad range of possible users but also due to a high user density. For example, there are only 22 active users on a conventional soccer field during normal match operation. In a skate park of comparable size, this figure is about three times as high. An additional factor is that skateparks and facilities for roller sports clearly differentiate themselves from conventional sporting facilities. While soccer fields or basketball courts are subject to clear dimensions and requirements, roller sports facilities can break down these restrictions. The combination of different sports equipment, varying focal points

"Inner-city or near-city spaces should be transformed into sports and movement parks with a wide range of uses (e.g. open trend sports facilities) and meeting places for young people and adults." Prof. Dr Phil. Robin S. Kähler (board member of the International Association of Sports and Leisure Facilities)

or the design as a meeting place make skateparks stand out from the mass of sporting facilities. With a skatepark, municipal open space is not only used efficiently but is also valued accordingly. After all, only a contemporary sporting facility, tailored to an individual's changing needs for self-determined sporting activities, values public space as a finite resource.



SPORTSGROUND2.0

The skatepark as a communal sporting facility

Looking at municipalities and sporting facilities in Germany and Austria, many similarities can be seen: Under high pressure to adapt and change, both must face a variety of challenges such as demographic change, changes in educational policies, shifts in sporting interests, structural crises in public financing, etc. The logical conclusion is that both areas support each other in solving these problems. Skateparks manage this balancing act as they are future-oriented sporting facilities. Each one is, a so-called sports ground 2.0.

Modern sporting facilities focus mainly on topics such as the attractiveness of the location, education, health and social integration. Thereby the requirements for a sports ground 2.0 become clear: It must be sustainable/long-lasting, offer a high social added value (a good social return) and at the same time be versatile and attractive for as broad a user group as possible. Municipalities need a long-term location for many types of sport, instead of multiple facilities accommodating only one type of sport at a time.

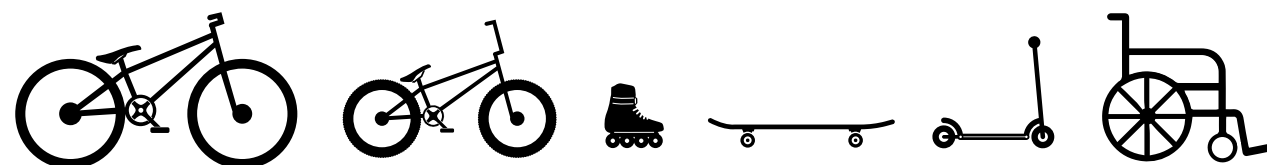

The skatepark meets exactly these requirements:

- Variety of user groups: Skate & Longboard, BMX, Scooter, Inline skates, Dirt bike and wheelchairs.
- Skateparks are low-maintenance, safe from vandalism and therefore extremely durable as municipal sporting facilities.

Roller sport is intuitive, fun and perfectly fits the self-determined sports behavior of teenagers and adults. Various roller sports can be carried out across generations on one course, regardless of ability and riding style. For municipalities, a roller sports facility is the ideal way to promote physical activity.

The motto is:



"Turn off your phone, drop the burger and hop into the skate park".

Skate facilities as a cure for social and health-related problems in young people.

Using a skatepark means...

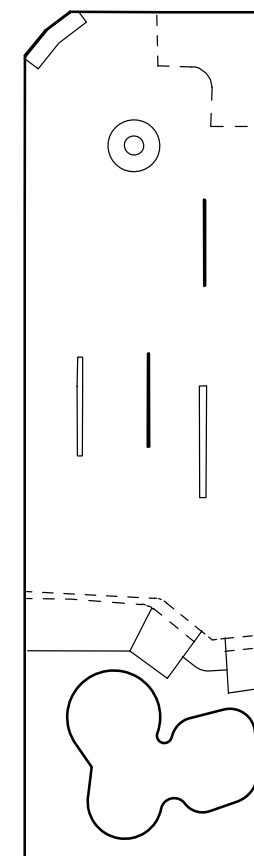

...less time on your phone.



...burning calories.



...inclusion and experiencing social encounters.

The combination of movement, fun, safety and the variety of user groups sets this facility apart from others.

From the perspective of municipal sporting facility planning, there are decisive advantages for skateparks.

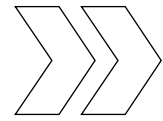

Variety of user groups:

- Skateboard
- BMX
- Scooter
- Dirt bike
- Inline Skates
- Wheelchair

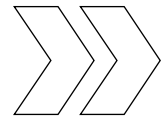

Safety:

Skateparks are standardized according to the European safety requirements and test methods EN 14974: 2019.



Municipal open spaces are redefined:

- Creation of a modern and multifunctional facility.
- Increase in the attractiveness of public space.
- Movement is actively and unconventionally promoted.
- Place of encounter and self-realization.
- Sports activities are consciously offered and encouraged.



Target groups of roller sports facilities

Roller sports facilities are not called multisport facilities without reason. Due to the characteristics of the facilities, there is an extremely broad target group, which is the perfect prerequisite for an urban / municipal sporting facility.



Skateboard



Inline Skates



BMX



Dirt bike



Scooter



Wheelchair

Skatepark Gersthofen

A skateboarder in a white t-shirt, black pants, and a black cap is captured mid-air, performing a trick. The skateboard is positioned below the skater's feet. The background shows a concrete skatepark with various ramps and ledges, surrounded by lush green trees under a clear blue sky.

In-situ
concrete

In-situ concrete Skateparks

Optimum riding characteristics, individual design options, best possible durability and safe from vandalism. This is how you can briefly describe the properties of an in-situ concrete skatepark. The build is concreted by wet spraying and then smoothed manually by experienced specialists in several careful work steps.

The in-situ concrete is applied to a reinforced base layer, simultaneously compacted and finally shaped, smoothed and polished. The conditions on-site, the available budget and special user wishes can be considered individually during the planning and construction of an in-situ concrete skatepark.

The result is an almost maintenance-free sports facility with organic molds made of one cast and manufactured according to the standard for roller sports facilities EN 14974:2019.

- Individually and organically modelled in-situ concrete landscapes
- Multiple levels (B-, C-level)

- Steel fixtures (e.g. rails, copings) made of hot-dip galvanized steel
- Meets all requirements of the EN 14974:2019 standard
- Edge protection and copings made of hot-dip galvanized steel or other low-wear materials (granite, marble, etc.)

Characteristics

construction measures



current costs



cost per square meter

from 201 €		
€ 0-50	€ 51-200	€ 201-500



Skatepark Gersthofen

Gersthofen | Germany, 2018/2019

Area: approx. 900 m²

Order total: 337.849, -€ (net)

Client: City of Gersthofen

Services of Schneestern: deconstruction of old structures, earthworks, terrain modelling, steel-works, formwork operations, concrete works

● **Bowl**
Area: approx. 200 m²

● **Plaza & Flat**
Area: approx. 700 m²

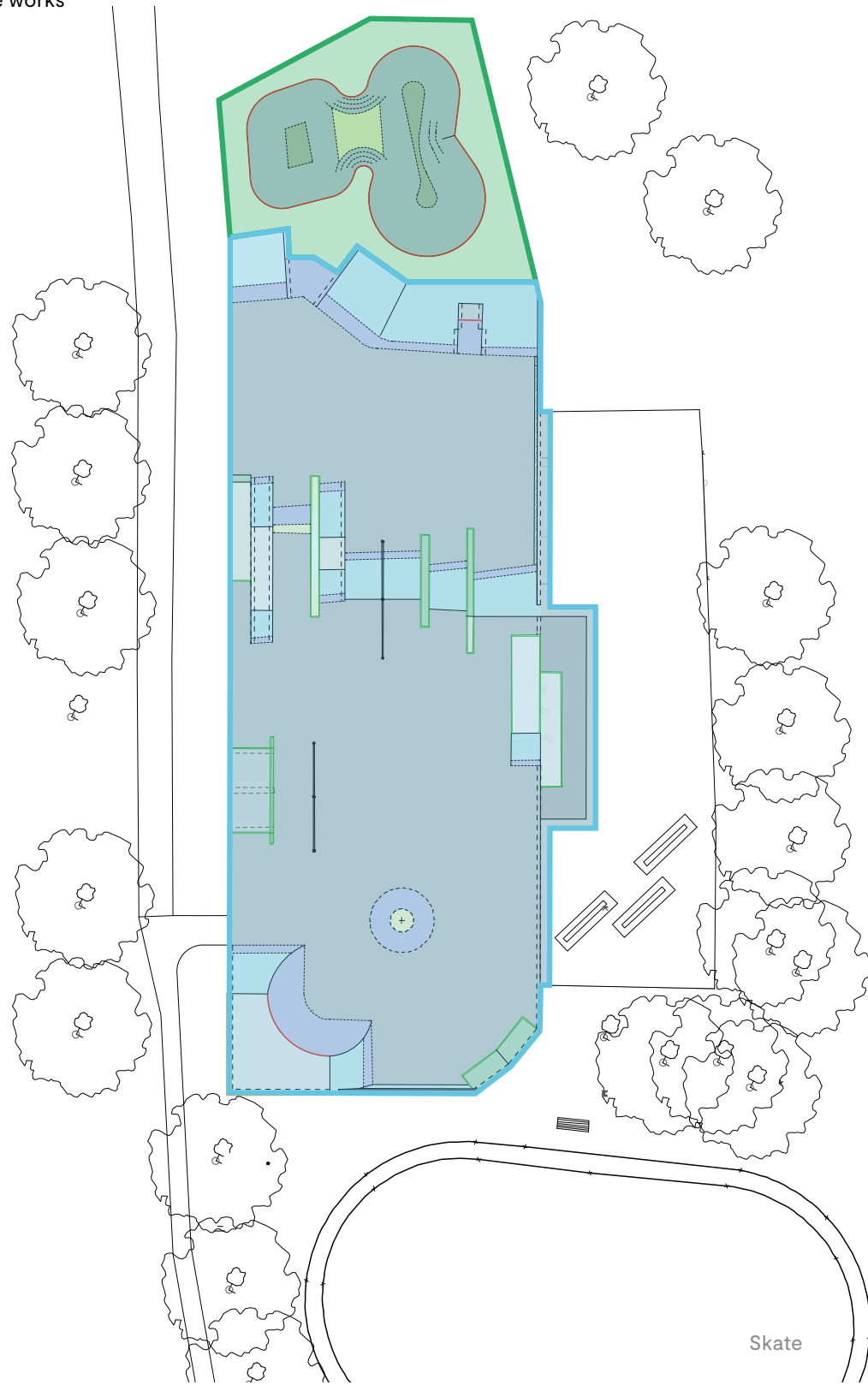

**Be inspired
and build your
individual
skate park
with us!**

Facility description

The unique skate park in the town of Gersthofen can be used by beginners and experienced skaters as a creative endless loop through many freely selectable lines. The area offers many ways to individually design the free ride. At peak times with a high visitor frequency, the facility can be divided into two areas for sports functions, thus managing the athletes.

In the skate street area, a street-like course with various elements such as curbs, ledges, a wobble, banks and quarter pipes in differing combinations is set up. On two levels, experienced riders can perform the most difficult tricks, while less experienced riders can explore the rides and waves in a flat environment.

The Bowl area is separated from the Skate Street area and is not used in conjunction. The flat area of the bowl can also be used as a mini ramp to practice lip tricks on the edge of the bowl. Due to its elevated location, separate access and generous stand space, the area offers a good view of the entire park for spectators. All parts of the bowl are individually shaped, resulting in a versatile and unique facility for all roller sports equipment.



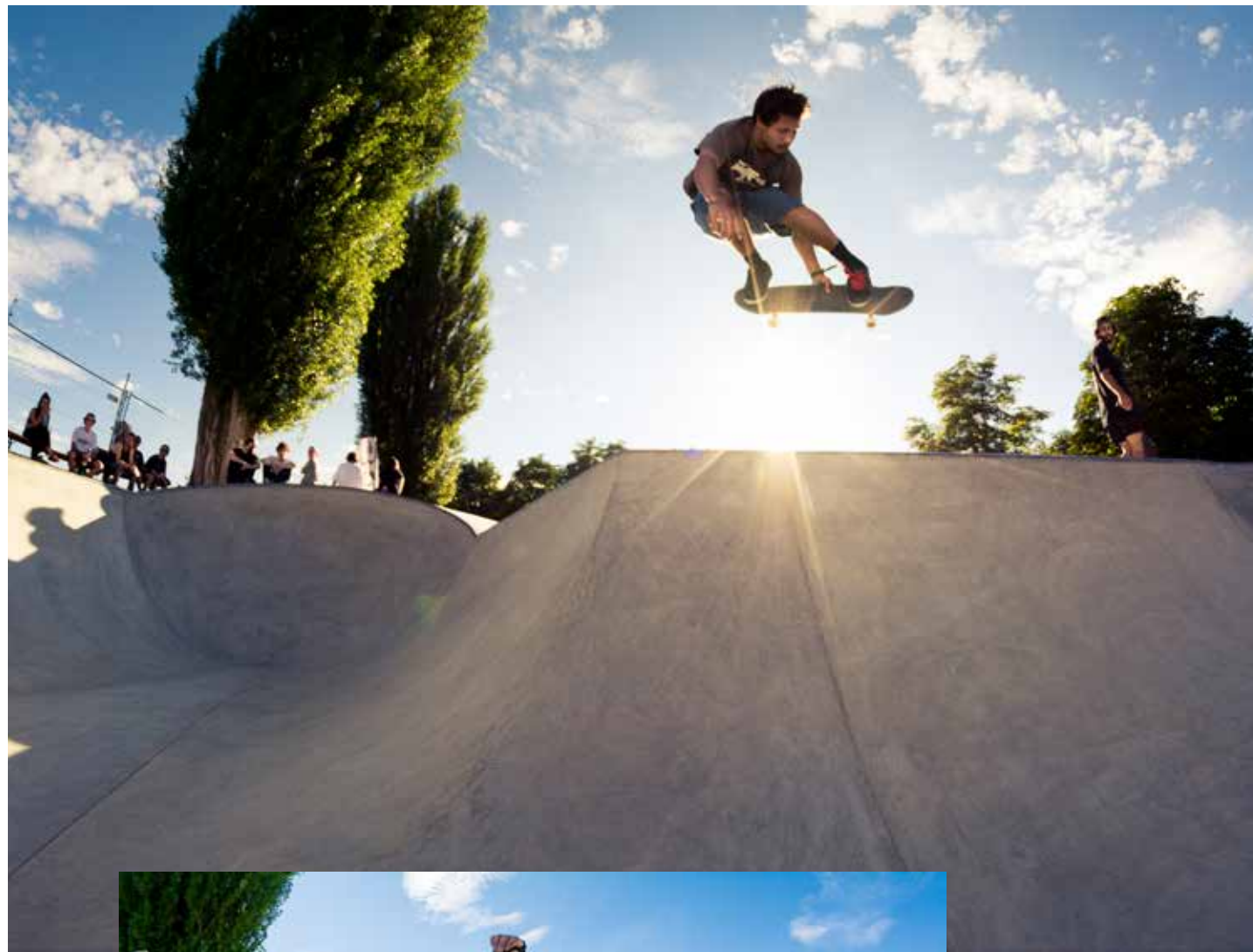

Skatepark Augsburg Reese

Augsburg | Germany, 2019
 Area: approx. 1,500 m²
 Order total: 375.320, -€ (net)
 Client: Society for Urban Development Augsburg
 Services of Schneestern: earthworks, terrain modelling,
 steelworks, formwork operations, concrete works,
 landscaping



Skatebowl Illerdamm

Kempton | Germany, 2016
 Area: approx. 250 m²
 Order total: 43.243, -€ (net)
 Client: City of Kempton
 Services of Schneestern: 3D visualization, construction planning and site management,
 measuring, drainage, steelworks (production of copings)

Skatepark Gummersbach

Gummersbach | Germany, 2017

Area: approx. 700 m²

Order total: 129.131, -€ (net)

Client: Gerhard Müller Bauunternehmung GmbH

Services of Schneestern: earthworks, terrain modeling, steelworks, formwork operations, concrete works





Skatepark Hennef

Hennef | Germany, 2017
 Area: approx. 500 m²
 Order total: 117.505, -€ (net)
 Client: City of Hennef
 Services of Schneestern: earthworks, terrain modelling, steelworks, formwork operations, concrete works



Skatepark Neuaubing

Munich | Germany, 2018
 Area: approx. 600 m²
 Order total: 268.365, -€ (net)
 Client: City of Munich
 Services of Schneestern: earthworks, terrain modelling, steelworks, formwork operations, concrete works

Skatebowl Waldsport- anlage Eberswalde

Eberswalde | Germany, 2019

Surface area: 383 m²

Order total: approx. 150.000, -€ (net)

Client: GaLa Tiefbau GmbH

Services of Schneestern: design, planning, earthworks, terrain modelling,
steelworks, formwork operations, concrete works

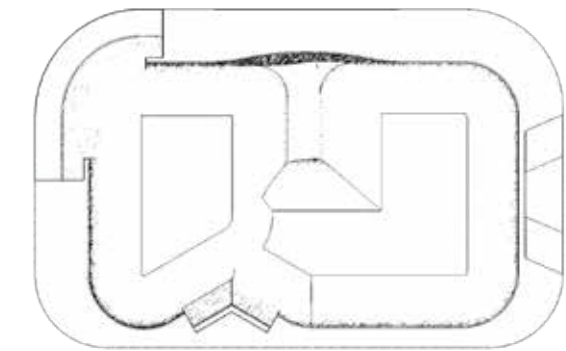
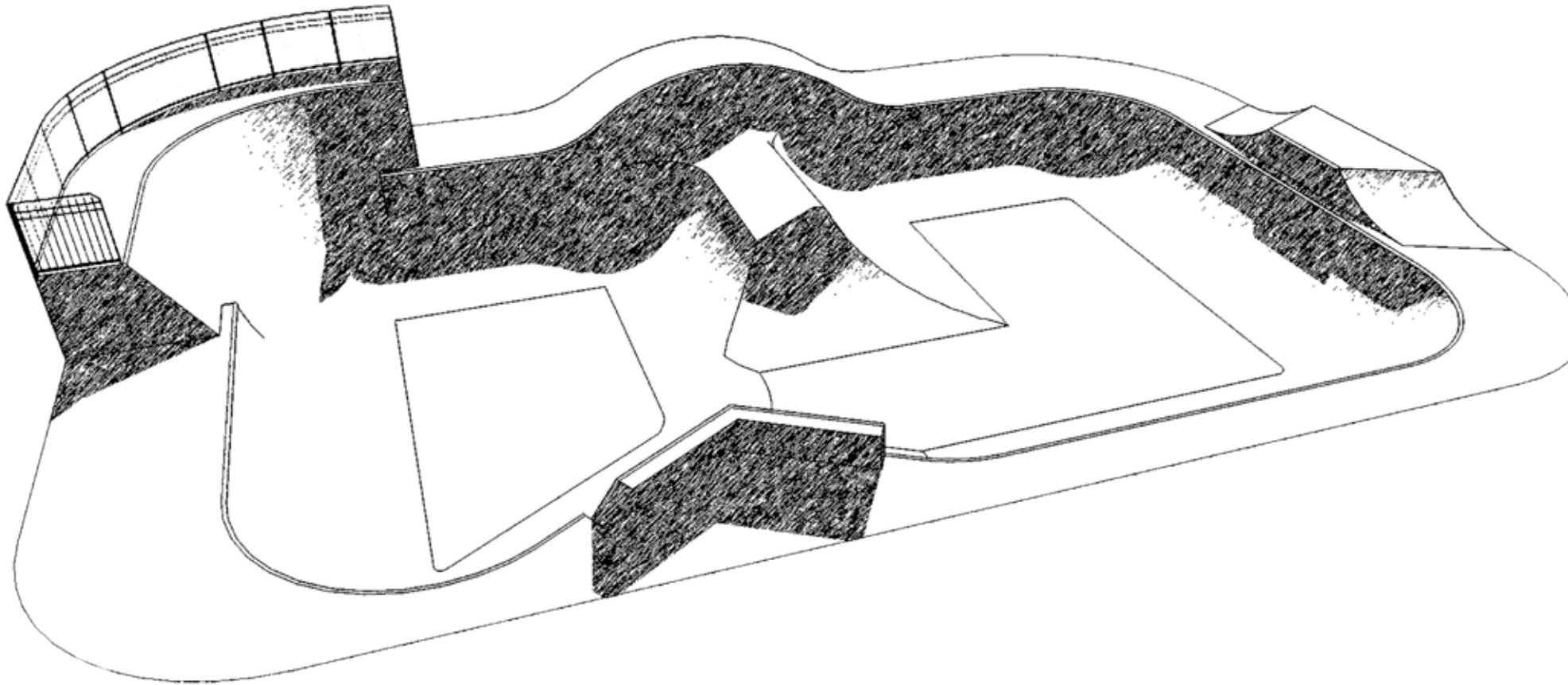

Schnitt A-A', M 1:100

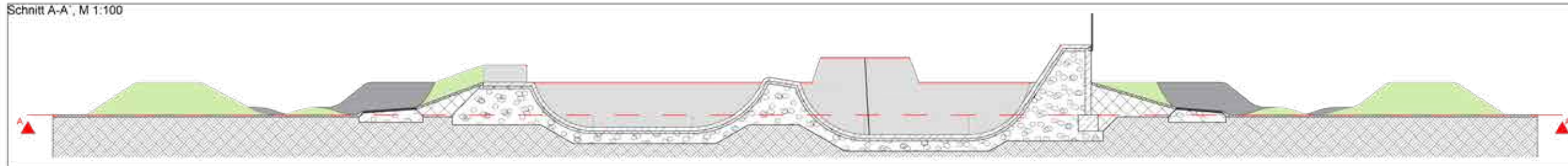

Schnitt B-B', M 1:100

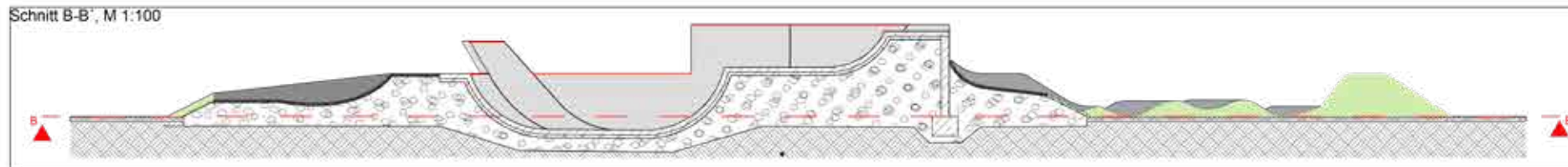

Schnitt C-C', M 1:100

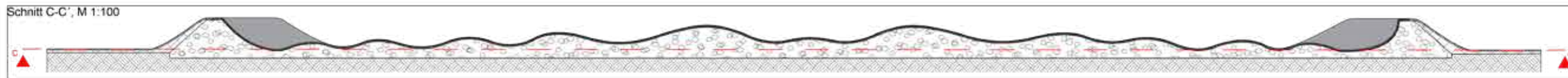

- Schnittlinie
- Coping, Stahlrohr 60,3*4 mm, feuerverzinkt, offene Enden verschlossen
- Geländer, Rahmen Rundrohr 42,4*3,6 mm, Füllung mit Staketen aus Vollmaterial D=16 mm, Pfosten Flachstahl 40*20mm angeschweißt an Ankerplatte 200*200*10 mm, feuerverzinkt, offene Enden verschlossen
- Asphalt Ac 8 TD 70/100, Ansicht
- Asphalt Ac 8 TD 70/100, Schnitt
- Beton C 35/45, "Verschleißschicht", Ansicht
- Beton C 35/45, "Verschleißschicht", Schnitt
- Beton C 8/10, "Sauberkeitsschicht"
- Kombinierte Frost-Tragschicht, Schotter 0/32
- Gewachsenes Erdreich, Untergrund
- Unterboden
- Oberboden
- Vegetation



Asphalt

Asphalt Skateparks

An asphalt skate park can be very simple in its basic requirements. In principle, a flat open space is enough, and a park can be constructed. However, the complete opposite is equally conceivable: Individually modelled asphalt landscapes spreading across several levels with a variety of ramps. Asphalt skateparks can be perfectly adapted to the available budget within the scope of the project.

The surface of the skatepark is asphalted with a fine grain mix irrespective of its size. Afterwards, the individually designed ramps are placed on it. All ramps are built in our TÜV-certified production facility and consist of a durable substructure made of hot-dip galvanized steel and a specially developed, low-noise skate coating.

In cooperation with you, we design a skate park tailored to your budget which will be manufactured according to the DIN EN 14974:2019 standard for roller sports facilities.

- Individually modelled asphalt landscapes
- Multiple levels (B-, C-level) and curved forms
- Substructures made of hot-dip galvanized steel
- Specially developed, low-noise skate coating
- Meets all requirements of the standard DIN EN 14974:2019

Characteristics

construction measures



current costs



costs per square meter

	from 100 €	
€ 0-50	€ 51-200	€ 201-500



Skatepark Langenargen

Langenargen | Germany, 2017
 Area: approx. 750 m²
 Order total: approx. 120.000,- € (net)
 Client: City of Langenargen
 Services of Schneestern: deconstruction of old structures, 3D visualization, design, planning, terrain modelling, steelworks, ramp construction

PYRA

Dimensions: 6,1 x 7 x 1 m (l x w x h)
 Material: Five-piece, hot-dip galvanized steel construction with larch and grey 8mm composite skate planking, sides covered with 8mm composite panels featuring China bench, Flat rail, Curbe
 € 16.000,- (net)



Facility Description:

Skateparks are available in all shapes and sizes. When a city or municipality works towards a new public skatepark, it faces several decisions. Is there an existing area? Is it attractively located? Is it big enough for the reorientation? How are the existing installations handled? In the town of Langenargen, many of these possibilities were discussed in the form of youth participation and the participation of those responsible. Decisions were made jointly.

We don't offer the Skatepark as a catalogue product, because all these topics dominate in almost every city or municipality. Roller sports facilities have been well established in society and we have developed a strategy to create an offer for future users with the highest possible identification. A flagship project or, in this case, a unique park with a rideable sail. A typical recognition feature of Lake Constance.

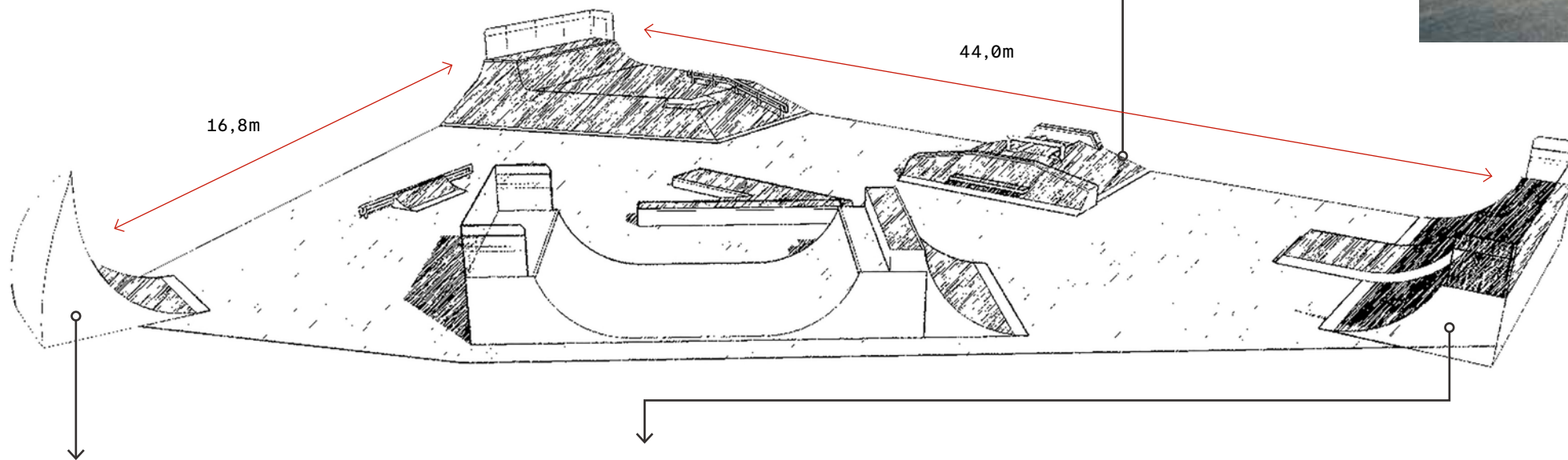

SAIL QUARTER

Dimensions: 3.4 x 3.6 x 3.5 m (l x w x h)
 Material: Four-part, galvanized steel construction with larch and grey 8mm composite skate covering, sides covered with 4mm composite panels.
 € 12.120,- (net)

QUARTER/ PAD

Dimensions: 10 x 6 x 1.6 m (l x w x h)
 Material: Hot-dip galvanized steel construction with larch and grey 8mm composite skate planking, sides uncovered incl. railings
 € 15.130,- (net)

Be inspired and build your individual skate park with us!



Skatepark Isny

Isny | Germany, 2016

Area: approx. 700 m²

Order total: 21.250, -€ (net)

Client: City of Isny

Services of Schneestern: deconstruction of old structures, planning, design, asphalt refurbishing, ramp construction

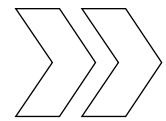

Sometimes less is more. In this case, it is important that the elements that are set up are of great quality. Now, classic elements like a rooftop, a wheelie table, a mini ramp or a halfpipe can be ordered and set up separately.

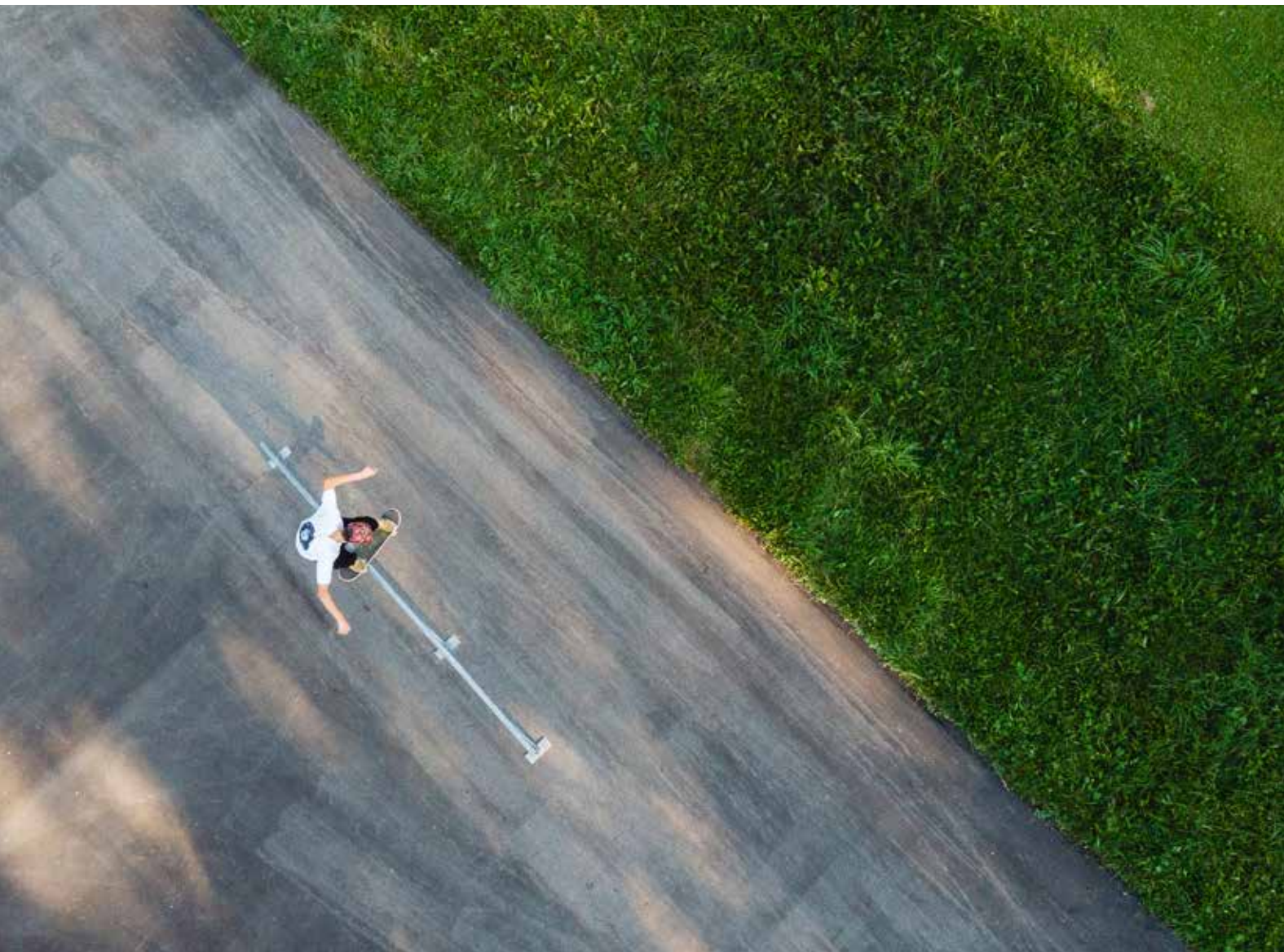

Skatepark Meran

Merano | Italy, 2016

Area: approx. 750 m²

Order total: 136.200, -€ (net)

Client: City of Merano

Services of Schneestern: planning, design, ramp construction

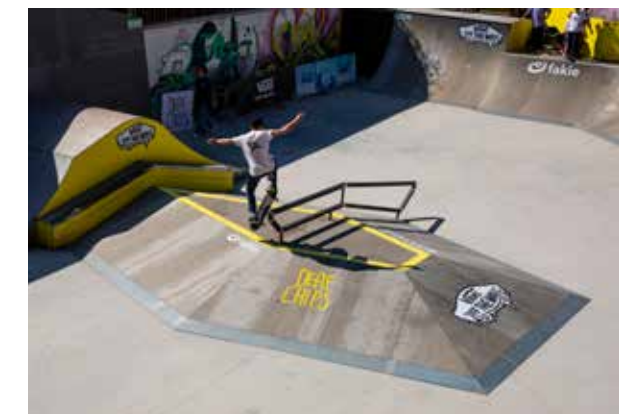



Indoor

Indoor skatepark Innsbruck

Indoor Park

Often enough, it can happen that the weather spoils one's plan when it comes to sports. In this case, an indoor park is an ideal opportunity to be active on a Skateboard, Longboard, BMX, Dirt bike, Scooter or Inline Skates in any weather and at any time of the year. The Indoor Park is exactly what you make of it: In-situ concrete elements, ramps, rails or simply all the above. The possibilities and combinations are endless and depend mainly on the available space and the needs of the users. With such a facility, fun, exercise and social engagement can be combined under one roof regardless of the weather. In addition, commercial use is an obvious option.

- Optional organic concrete elements or ramps, available also in combination
- Weather-safe
- Targeted management of users and ideal for an operator concept
- Multiple levels (B-, C-level)

- Meets all requirements of the standard DIN EN 14974:2019
- Steel fixtures (e.g. rails, copings) made of hot-dip galvanized steel
- Substructures made of hot-dip galvanized steel
- Specially developed, low-noise skate coating

Characteristics

construction measures



current costs



costs per square meter

	individually	
€ 0-50	€ 51-200	€ 201-500

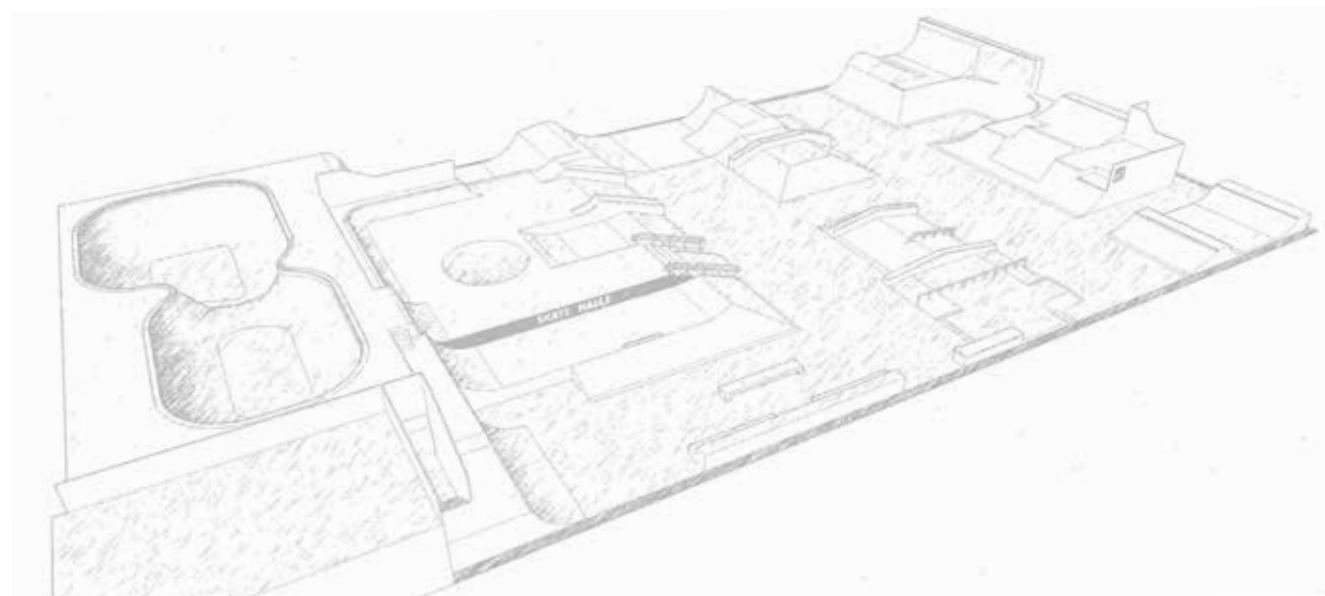



Indoor skatepark Innsbruck

Innsbruck | Austria, 2019

Area: approx. 1300 m²

Order total: approx. 150.000, -€ (net)

Client: Olympic Sports and Event Centre Innsbruck Ltd

Services of Schneestern: 3D visualization, design,
planning, complete structural refurbishment



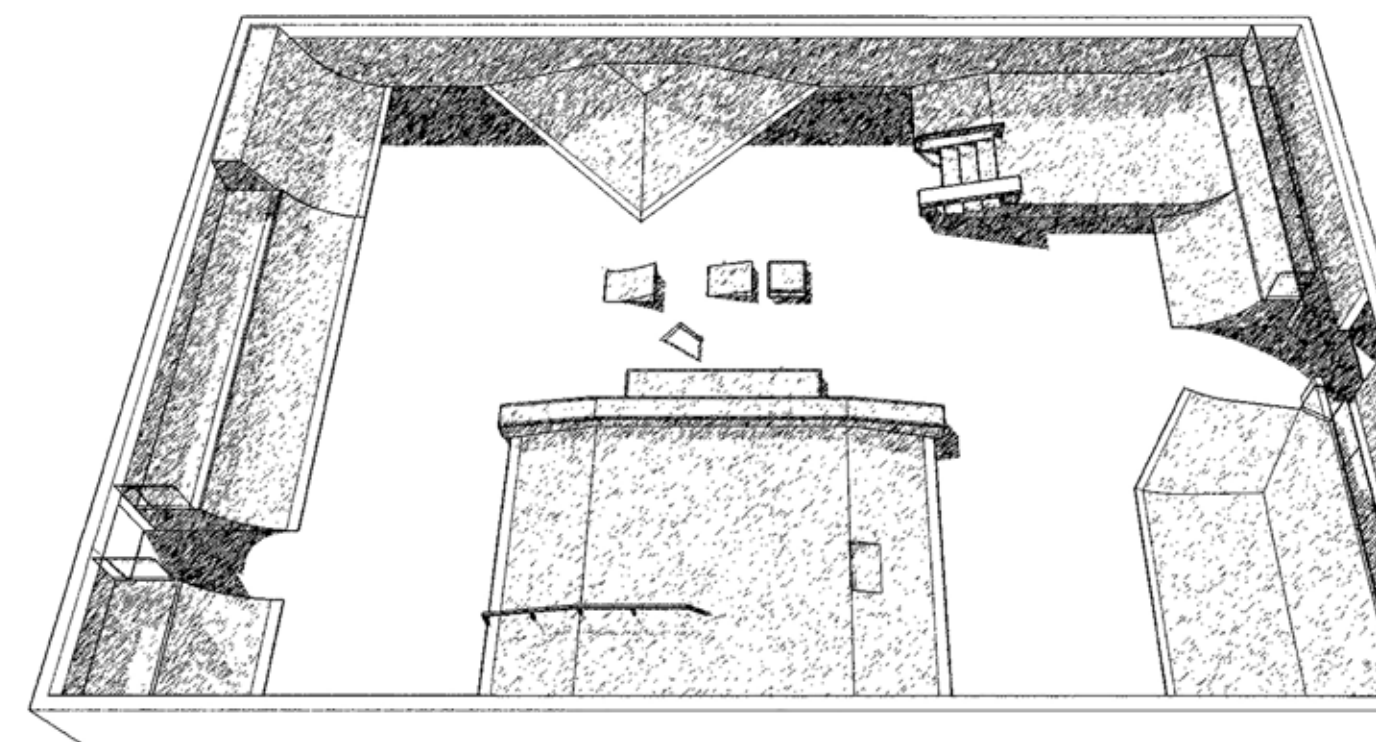

Remscheid

Remscheid | Germany, 2019

Area: approx. 500 m²

Order total: approx. 42.000,-€ (net)

Client: City of Remscheid

Services of Schneestern: design, 3D visualization,
planning, ramp construction

Skatepark Langenargen



Ramps & Equipment

Ramps & Equipment

Complete your offer!

You already have an existing skatepark and plan to expand it? You can also get individual ramps and obstacles such as rails individually manufactured by us, independently of complete facilities. All ramps and obstacles are manufactured in our TÜV-certified production facility and, depending on the design, consist of a durable substructure made of hot-dip galvanized steel and a specially developed, low-noise skate coating. The use of special materials such as marble or granite is also readily available. Upgrade your existing facilities with contemporary ramps and obstacles!

- Meets all requirements of the standard DIN EN 14974:2019
- Substructures made of hot-dip galvanized steel
- Specially developed and low-noise skate coating
- TÜV-certified production facility in Germany
- Special materials such as marble or granite are possible

Characteristics

construction measures



current costs



costs per square meter

	individually	
€ 0-50	€ 51-200	€ 201-500

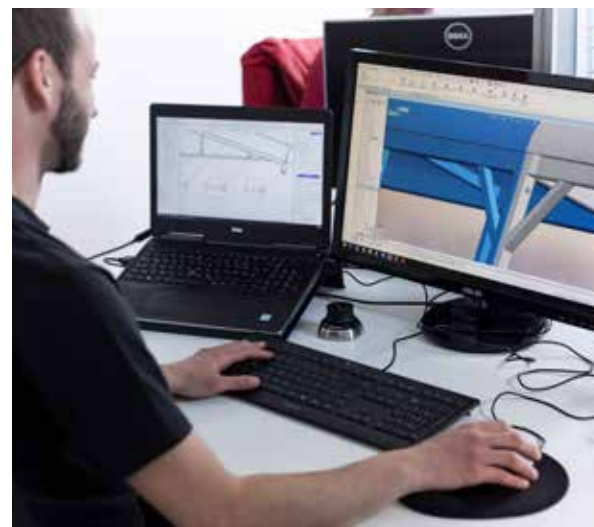



Waiblingen

Waiblingen | Germany, 2019
 Order total: 5.000, -€ (net)
 Client: Vans
 Services of Schneestern: Planning,
 ramp construction



Mini ramp Constance

Constance | Germany, 2017
 Order total: 82.000, -€ (net)
 Client: City of Constance
 Services of Schneestern:
 Foundation construction, planning, design,
 ramp construction



Buxheim

Buxheim | Germany, 2019
 Order total: 13.900, -€ (net)
 Client: Municipality of Buxheim
 Services of Schneestern: planning,
 design, ramp construction



Naturns

Naturns | Italy, 2015

Order total: 58.465, -€ (net)

Client: City of Naturns

Services of Schneestern: Planning, design,
ramp construction



Lana

Lana | Italy, 2017

Order total: 46.620, - € (net)

Client: City of Lana

Services of Schneestern: Plan-
ning, design, ramp construction



Uhldingen

Uhldingen | Germany, 2016

Order total: 23.000, -€ (net)

Client: Municipality of Uhldingen-Mühlhofen

Services of Schneestern: Planning, design,
ramp construction



Ulm

Ulm | Germany, 2018

Order total: Event sponsoring

Client: City of Ulm

Services of Schneestern: Plan-
ning, design, ramp construction





Munich Mash

Munich | Germany, 2019
 Order total: 1.700,- € (net)
 Client: Munich Mash-Further UG
 Services of Schneestern: Ramp construction - special construction



Freedom BMX Awards

Oldenburg Germany, 2018
 Order total: Event sponsoring | Client: Freedombmx
 Services of Schneestern: Ramp construction - special construction



Equipment Skate Park Marktoberdorf

Marktoberdorf / Germany, 2018
 Contract value: 5.100,- € (net) | Client: City of Markdorf | Services of Schneestern: design, ramp construction



Bench

BENCH CHILL BRO
 Order no. BENCH CHILL BRO
 Dimensions: 3,7 x 0,45 x 0,4 m (l x w x h)
 Material: hot-dip galvanized steel frame
 Seat: planked with skate coating
 Accessories: Floor anchorage set
 € 960,- (net)

Trash can

BARCA TRASH CAN
 Order no. BARCA TRASH CAN
 Dimensions: 2,2 x 0,45 x 0,9 m (l x w x h)
 Material: Powder-coated steel construction
 Color: all standard RAL colors possible without surcharge
 Accessories: Floor anchorage set
 € 1.390,- (net)



Refurbishment

There are many reasons why ramps in a skatepark must be renewed, no matter if they are worn out, weak or of poor quality. However, above all, safety is of the utmost priority. Only when all elements in a skatepark are in perfect condition, can the risk of injury be minimized, and the safety of the users be guaranteed. However, since often there is no budget to redesign a skatepark or individual elements from scratch, the refurbishment of existing facilities is a cost-effective alternative. We will ensure that your old skatepark shines in new glory.

Battening



Concrete Cosmetics + Sealing



Coatings



Copings



Rails



Substructures



Customer Service

Holistic support of our customers is of great importance to us. Therefore, we have created the world's first customer service in the action sports industry for our products. A 24hr hotline and an on-site service guarantee consistent quality, even as the use and complexity of our products increases.

OUR SERVICES: +49-831-960 886 56



- Emergency hotline
- On-site service
- Technical support in case of problems
- Carrying out repairs
- Europe-wide
- Replacement and maintenance work on your Schneestern products
- Regular inventory and documentation of damages

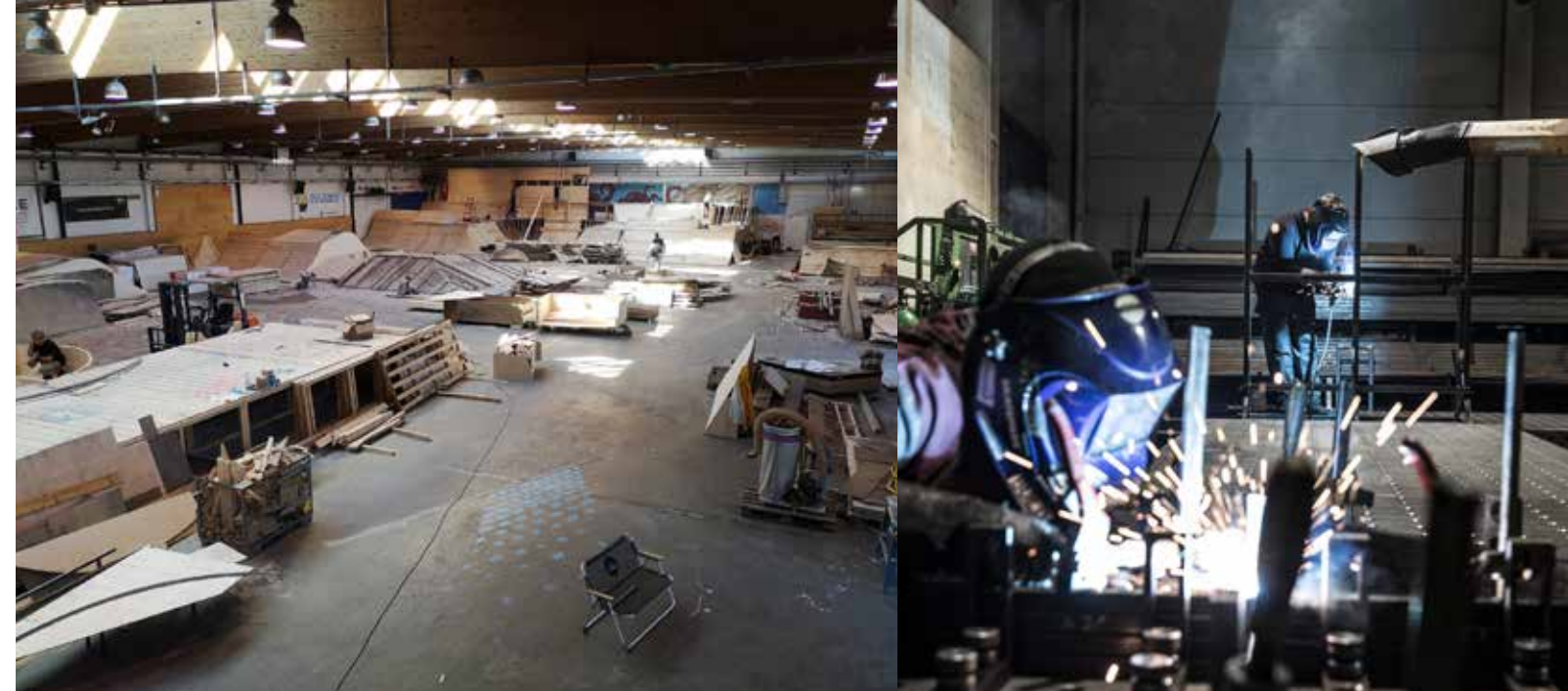



Halfpipe Illerdamm

Kempten | Germany, 2018
 Order total: approx. 15.000.-€ (net)
 Client: City of Kempten
 Services of Schneestern: planning, design, ramp construction



Neu-Ulm

Neu-Ulm | Germany, 2018
 Order total: 13.330.-€ (net)
 Client: City of Neu-Ulm
 Services of Schneestern: planning,
 design, ramp construction

References

SINCE 2012 MORE THAN 30 PROJECTS IN GERMANY, AUSTRIA AND ITALY



GERMANY

In-situ concrete parks:

- Kempten: Skatebowl
- Flensburg: Wallride-Combo
- Gummersbach: Skatepark
- Hennef: Skatepark
- München: Skatepark
- Gersthofen: Skatepark
- Augsburg: Skatepark
- Kernen: Skatebowl (April 2020)
- Eberswalde: Skatebowl (March 2020)

Asphalt parks:

- Oy-mediumberg: Skatepark
- Uhdlingen: Skatepark
- Langenargen: Skatepark

Ramps / Equipment:

- Konstanz: Mini ramp
- Buchenberg: Skatepark
- Nesselwang: Skatepark
- Isny: Skatepark
- Leipzig: Mini ramp
- Remscheid: Indoor skatepark
- Buxheim: Skatepark
- Neu-Ulm: Event-Equipment
- Munich Mash: Event-Equipment
- Oldenburg: Event-Equipment
- Kempten: Jumpline
- Waiblingen: Event-Equipment

Refurbishment:

- Ulm: Skatepark

AUSTRIA

Refurbishment:

- Innsbruck: Indoor skatepark

ITALY

Asphalt parks:

- Naturns: Skatepark
- Lana: Skatepark
- Meran: Skatepark
- Obermais: Mini ramp
- Vahrn: Skatepark

Service Portfolio

Planning & Construction

➔ For planners

➔ For builders

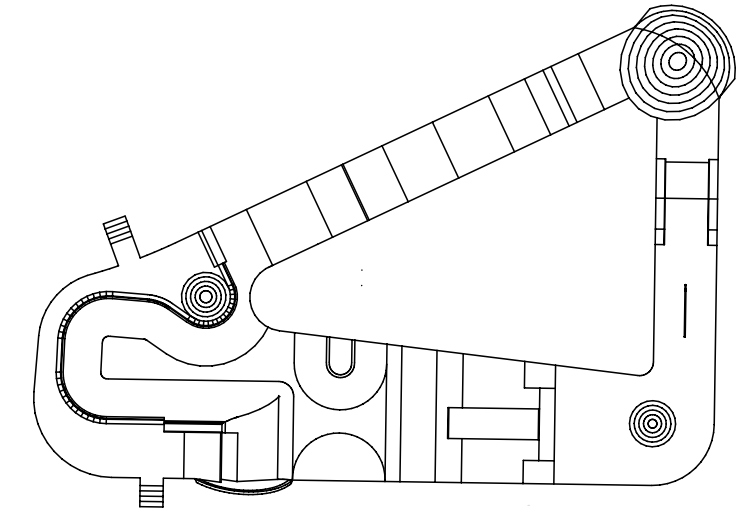

Acting as a subcontractor

1. Initial consultation and exchange of know-how

2. Analysis and fixation of requirements

3. Specialized contributory work as subcontractor (LP1 - 6):

- Basic assessment
- Preliminary planning and estimation of costs
- Information event and project presentation
- Participation process (stakeholder process)
- Draft planning and calculation of costs
- Implementation planning
- Submission of documents (e.g. building application)
- Approval and funding procedures
- Preparation of tender documents
- 3D visualization
- Safety and signage concept

Acting as sole contractor (§ 7c VOB/A 2019)

1. Planning and construction by a single company

Advantages:

- Lower overall project costs (planning + construction)
- Fixed-price contract guarantees cost security in planning and construction
- Faster project implementation
- Less project complexity (interfaces, contact persons, allocation, etc.)
- Optimal sports-functional and needs-based implementation

2. Specialist work in the planning phase

- Preparation and coordination of the performance program
- Preparation and coordination of sole contractor agreement
- Basic assessment
- Preliminary planning and estimation of costs
- Information event and project presentation
- Participation process (stakeholder process)
- Draft planning and calculation of costs
- Implementation planning
- Submission documents (e.g. building application)
- Approval and funding procedures
- Preparation of tender documents for subcontractors
- 3D visualization
- Safety and signage concept

3. Technical work in the execution of construction work

- Constructional realization according to plan
- Project management and documentation
- Quality assurance and construction supervision
- Subcontractor management
- Equipment supplier
- Initial safety inspection (e.g. TÜV)
- Care and maintenance work
- Staff training

4. Support and marketing

- Editorial articles in the trade press
- Photo and video production
- Opening event
- Highlight Events
- Testimonial Arrangements
- Sponsorship arrangement

Acting as building contractor (bidder)

1. Construction

- Constructional realization according to plan
- Project management and documentation
- Quality assurance and construction supervision
- Subcontractor management
- Equipment supplier
- Initial safety inspection (e.g. TÜV)
- Care and maintenance work
- Staff training

2. Renovation/Refurbishing

- Renovation of existing facilities

3. Support and marketing

- Editorial articles in the trade press
- Photo and video production
- Opening event
- Highlight Events
- Testimonial Arrangements
- Sponsorship arrangement

Do you have any questions?

We have the answers!

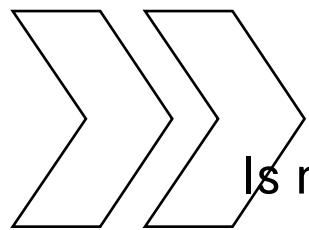

Is my location suitable?

What about vandalism?

What about the noise?

What running costs can I expect?

...

Your contact person

Let us take a solution-oriented approach!



With expert knowledge and the right understanding of the scene, I am ready to support you with your project! Your client advisor for BIKE & SKATE at Schneestern.

GREGOR PODLESNY



g.podlesny@schneestern.com



+49 -172-34 78 232

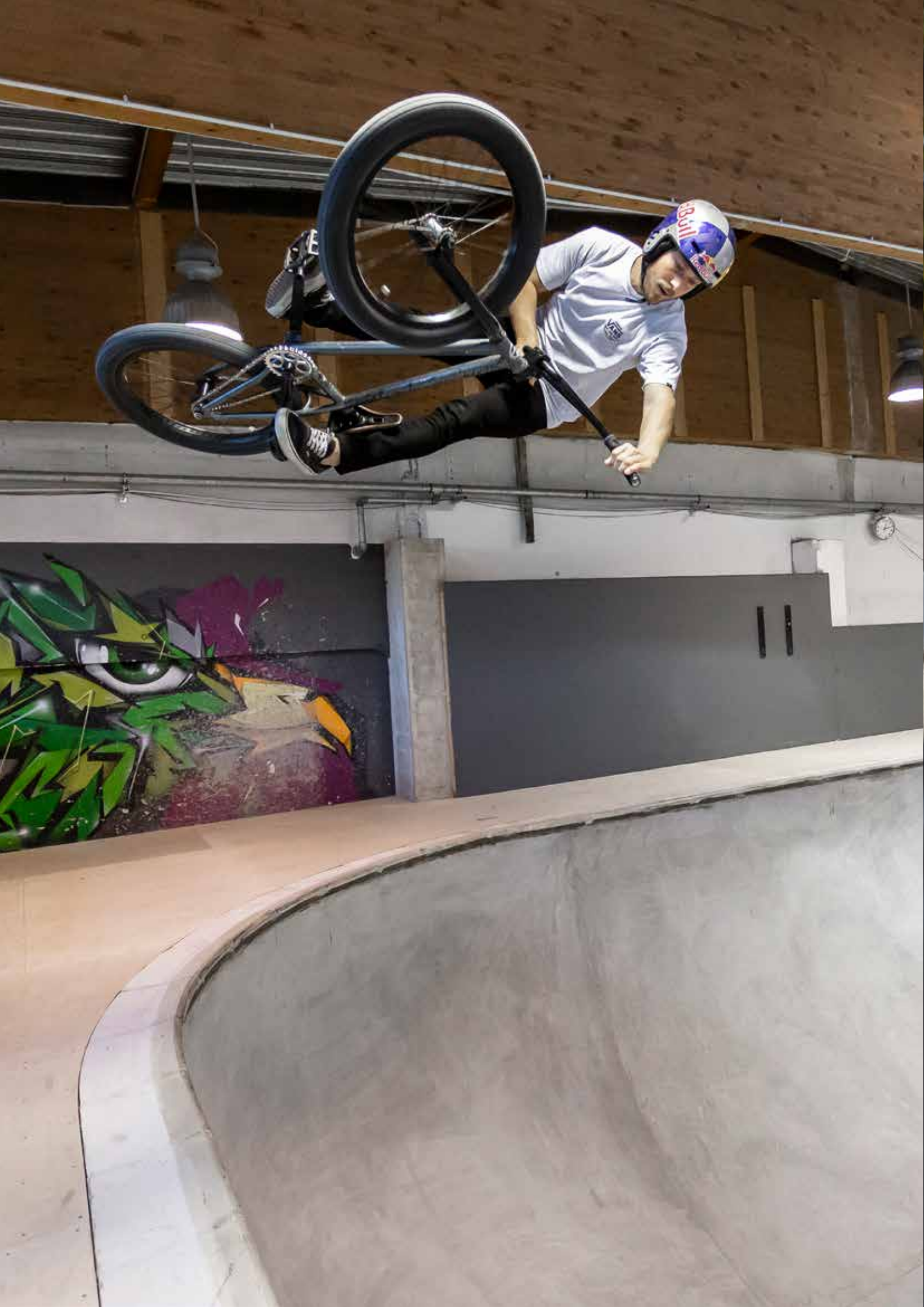



SNOW

BIKE

SKATE

WAKE

Schneestern? Who we are and what we can do!

Action sports is our DNA. But what does this mean? What are action sports? For us, it's the kind of sport that makes your pulse beat faster and always provides a little thrill. Action sports are unique, and this means that everyone can experience them in their own way. That's why the first ride on a pump track can be just as action-packed as the 100th jump at the X-Games.

Opposites that are not really opposites and yet determine our daily work. We have made it our task to make action sports a real experience for everyone, bringing it from the professionals to the broad masses. We plan, design - and discard again if something does not entirely meet our expectations. And we do so until everything is perfect. We have been using our know-how since 1999. We go to the office, to the workshop, up the mountain or to the construction site every day, to make action sports safe and to further establish what we love sustainably. Both regionally and globally.

How do we do that?

By transferring knowledge from conventional engineering disciplines into an unusual environment. By not allowing ourselves any mistakes in a world full of freestyle and by putting quality and safety first. Action sport is both a trendsetter and a constant. What used to be a laughed at niche sport is now an official Olympic discipline. Action sports are more than just a trick. It is the physical and mental orientation towards a sporting experience.

We recognized this development a long time ago and see it as the answer to the needs of our customers. We are aware of the positive effects of the sport itself, simply because we recognize ourselves in the joy of the first trick landed on a skateboard, bike, snowboard or free ski. Moments of detail that once again sharpen our view of the big picture: To further anchor SNOW, BIKE, SKATE and WAKE in society. Because we believe in it and because we can do it:

Action Sports engineered!



SNOW

The roots of Schneestern (in English "Snowstar") lie, as the name suggests, in the snow. To this day we have remained loyal to this division and build snow parks, events and the therefore suitable equipment worldwide. We are pioneers and market leaders in these areas and want to continue to support children, beginners and professionals alike when it comes to action sports during winter. From simple slopestyle for children to top events such as the X-Games Oslo, Air + Style, Audi Nines or the Olympic Games, we stand for winter action sports.



BIKE

Since 2014, we have been planning and implementing well-thought-out and sustainable bike trails and facilities. This division surrounding pump tracks, single trails and co. has meanwhile become an important pillar of Schneestern. A product range that primarily aims to generate added value and benefits for our customers while helping them master their challenges with suitable solutions. We want to help cities, communities, planners, mountain cableways, tourist destinations and sports clubs to fully utilize the potential of bike trails and facilities for their own purposes and thereby generate a positive impact for society today and in the future.



SKATE

Skateboarding, the mother of action sports. It goes without saying that in a company where everything revolves around action sports, this division should not be missing. We have been realizing skateparks for public spaces since 2012 and therefore want to promote action sports as well as individual sports for as broad a target group as possible. When it comes to skateparks, we serve the entire range of this sport using asphalt and in-situ concrete parks as well as ramps.



WAKE

In the 20 years of our company's history, we have worked hard to acquire the know-how and the quality regarding our snow park equipment. We have also transferred this gathered knowledge to our WAKE division and have been successfully producing professional wakeboard obstacles since 2013. This is a business area which we will continue to expand in the future.



Network of partners

We rely on a strong network to utilize synergies and to collectively push the bike sport forward. Therefore, we are proud members and networkers of the following partners.

MEMBERS OF:

HWK: Swabian Chamber of Trade



IHK: Chamber of Industry and Commerce



IAKS: International Association of Sports and Leisure Facilities



FLL: Research Society for Landscape Development Landscaping



COOPERATIONS PARTNERS:

Zeppelin Rental



Festool



Helly Hansen



More catalogues



Bike & Bike-Pumptrack

Request your free copy now. We will be happy to send it to you!



Snow-Equipment & Snow-Parks

Contact



+49 831 960 886 10



skate@schneestern.com



Schneestern GmbH & Co KG
Werner-von-Siemens-Str. 47
87471 Durach · Germany



www.schneestern.com/skate

Imprint

t: +49 (0) 831-960886-10
f: +49 (0) 831-960886-40

Schneestern GmbH & Co. KG
Werner-von-Siemens-Strasse 47, D-87471 Durach

Schneestern GmbH & Co. KG · Legal form: Limited partnership · Location: Durach · Register court: Kempten HRA 8156 · Personally liable partner: Schneestern Management GmbH · VAT ID No: DE 254363841 · Managing Director: Dirk Scheumann, Kai Siebdrath · Bank: Raiffeisenbank Kempten · IBAN: DE62 7336 9920 0100 2037 85 · BIC: GENODEF1SFO

Imprint

- Matthias Schwarz
- Jens Scheibe
- Jannik Steiner
- Beat Schwiersch
- David Malacrida
- Daniel Deak Bardos
- Steffen Vollert
- Gregor Podlesny
- Further UG
- Andi Weiland, Gesellschaftsbilder.de
- Das Kraftbild HWK
- Sebastian Marggraff
- F-Tech
- Picasa
- Jakob Brechensbauer

action sports engineered